

AEOLUS

Professional Pet Drying Equipments Supplier

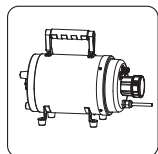

TD-901T

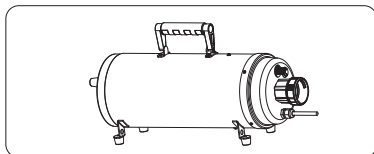

TD-900XT

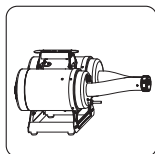

TD-900CG

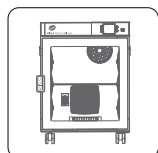

TD-907T

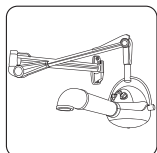

TD-905



TD-906

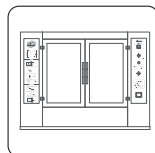

TD-907L

Distributor Contacts



AEOLUS

Producer: Shanghai TOEX International Trading Co., Ltd.
Address: Room 403, Building 3, No. 288, Qianfan Road,
Songjiang District, Shanghai, China.

Manufacturer: Shanghai Xunyuan Industrial Co., Ltd.
Address: Lane 29, No.1509 East Qianming Road,
Fengjing Town, Jinshan District, Shanghai.



AEOLUS

Ultimate Hands-Free Pet Dryer

TD-912

New
Generation

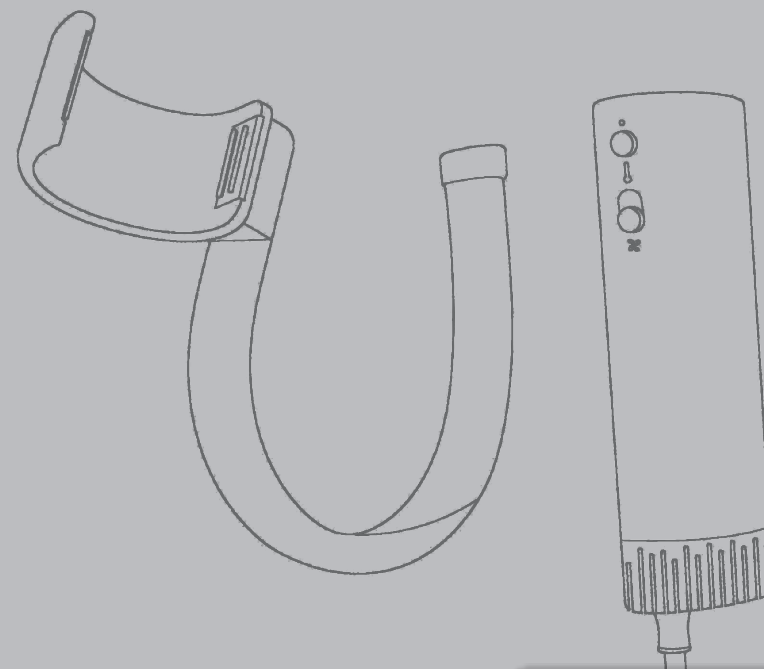

User Manual

Pro *for* Pros

Brief Introduction

AEOLUS HANDS-FREE PET DRYER TD-912, features negative ion hair care technology (2×10^8 ions/cm³), balanced heat distribution, cool air protection, low-noise design, automatic self-cleaning, and multiple safety protections, helping groomers and pet owners with ultimate easy operation.

Technical Specifications

Rated Voltage	220V
Rated Frequency	50Hz
Rated Power	1400W
Net Weight	235g
Product Dimensions	165mm×57mm×39mm

Main Technical Indicators

Motor Protection	Low Voltage Protection: AC 160V Over-voltage Protection: AC 265V Locked-Rotor Protection Temperature Protection Over-current Protection
NTC Protection	NTC Short-Circuit Protection NTC Over-Temperature Protection: 110°C NTC Open-Circuit Protection

Part List

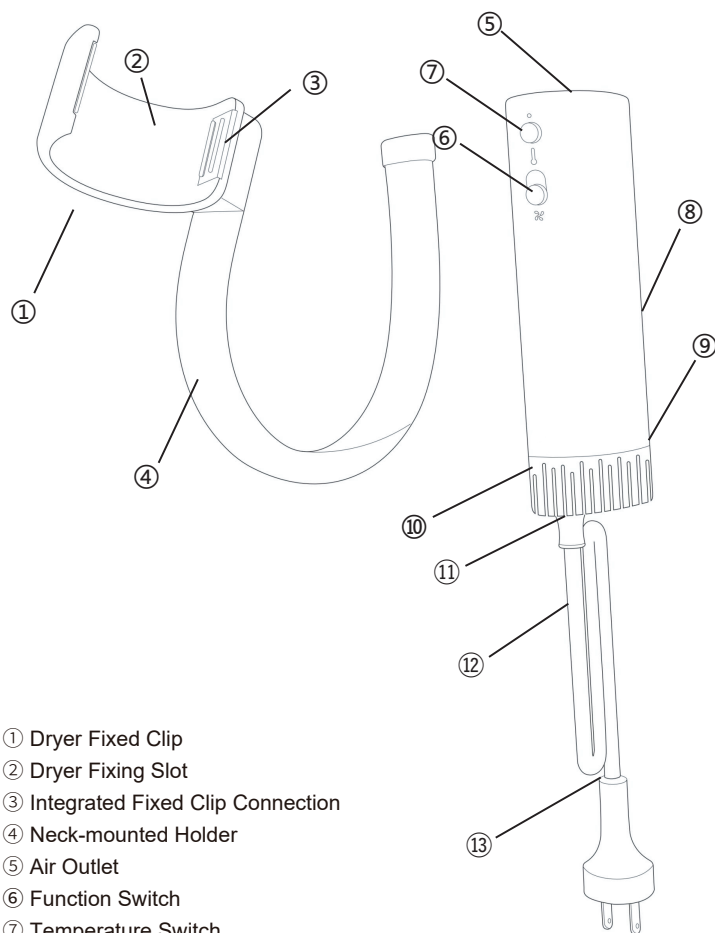

- ① Dryer Fixed Clip
- ② Dryer Fixing Slot
- ③ Integrated Fixed Clip Connection
- ④ Neck-mounted Holder
- ⑤ Air Outlet
- ⑥ Function Switch
- ⑦ Temperature Switch
- ⑧ Dryer Main Body
- ⑨ Air Inlet Cap (Rotary)
- ⑩ Air Inlet Mesh
- ⑪ Cord Sleeve
- ⑫ Power Cord
- ⑬ Plug

Safety Warning

- 1.The dryer must be used with a standard power outlet. Ensure that the voltage used matches the rated voltage indicated on the unit.
- 2.During use, the air outlet may become hot. Do not touch it directly.
- 3.After use, never leave the dryer running unattended. Always turn off the power and unplug it.
- 4.Children must not use the dryer alone. If used by children, they must be closely supervised.
- 5.If the dryer operates intermittently or irregularly, stop using it immediately.
- 6.Do not pull, damage, or modify the power cord. If the power cord or plug is damaged or overheated, stop using the unit immediately and contact the company's after-sales service for professional replacement.
- 7.Avoid dropping the dryer or subjecting it to strong impacts.
- 8.Do not use the dryer near explosive or hazardous substances, corrosive gases, flammable materials, or conductive dust that may damage insulation.
- 9.Do not place or store the dryer near sinks, water, other containers of liquid, or in highly humid areas. Do not expose the unit to direct sunlight.
- 10.If the air inlet or outlet becomes blocked by hair or dust during use, stop immediately, turn off the power, unplug the unit, and remove the obstruction. The dryer can resume normal operation after a few minutes.
- 11.Do not use thinner, toluene, or other solvents to clean the dryer.

Operation

- 1.When using the dryer, insert the plug into the socket, hang the holder around your neck, and push the switch to start. This allows you to free your hands for drying work.

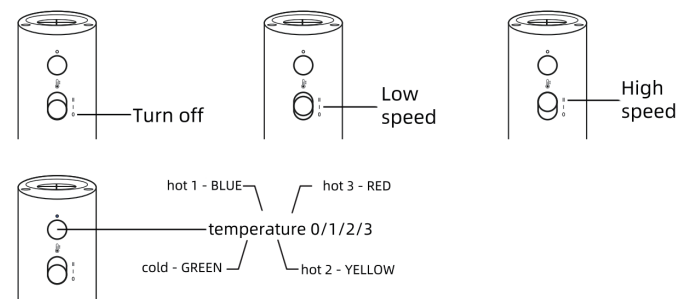

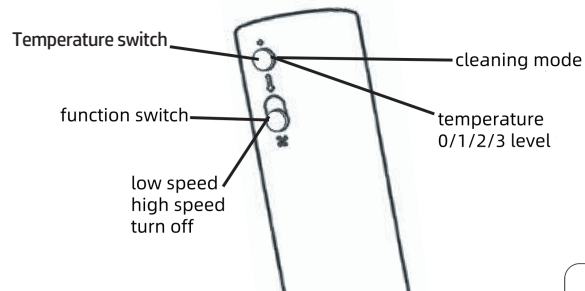

2. When using the dryer, hang the neck-mounted holder around your neck, ensuring that the holder opening, the dryer air outlet, and your face are oriented in the same direction. After hanging, adjust the width according to your neck size. Make sure the holder is securely fixed and the unit remains balanced before switching on the power.

3. After operation, set the power switch to the OFF position, and then unplug the plug.

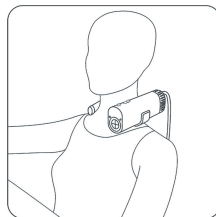

Maintenance

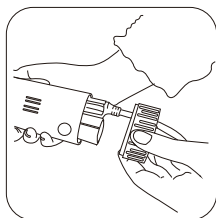

1. Remove the air inlet mesh

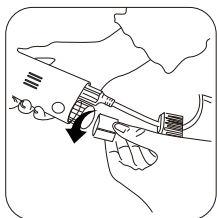

2. Remove the inner filter by turning it counterclockwise



3. Rinse the filter and air inlet mesh with tap water to remove dust and hair residues.

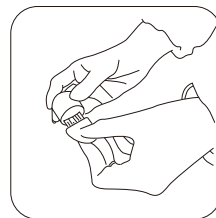

4. Or use a small brush to clean the dust and hair residues inside the filter

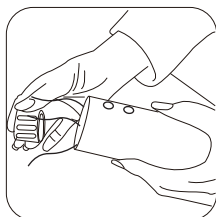

5. Dry the filters by the dryer

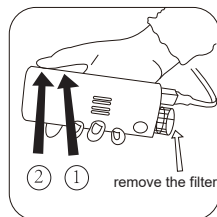

6. Turn on the dryer, then press and hold the S1 button for 3 seconds to clean the filter

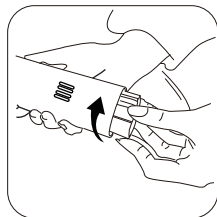

7. Install the filter by turning it clockwise, and ensure it is securely in place.

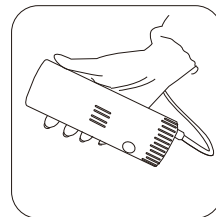

8. Reinstall the air inlet mesh to complete the cleaning process

*When entering cleaning mode, the dryer will reverse-blow for 10 seconds. After 10 seconds, the dryer will flash a red light and pause blowing.

Once cleaning mode is finished, restart the power to resume normal operation.

ATTENTION: All of the above operations must be performed with the power plug disconnected. During the cleaning process, the filter must be removed.

NOTICE

1. Since the filter is an ultra-precision component, do not use excessive force when installing or removing it to avoid damage.

2. Regular deep cleaning of the machine and filter is required:

① After each use, the reverse-blow cleaning function can be used several times to clean the machine.

② For pet shops: perform deep maintenance cleaning every 3 days; for pet households: perform deep maintenance cleaning every 3 months. Remove the filter, wash it with warm water, dry it (air-dry or blow-dry), and clean any hair or dust near the filter port with a small brush or tweezers. Finally, reinstall the filter.

3. Avoid exposing the filter to chemicals, strong impacts, or pressure.

4. The dryer must not be used without the filter installed. If the machine is operated without the filter and damage occurs, the repair costs must be borne by the user.

Service Support

Contact us if you cannot solve your problem with this manual.

Dallas

3249 Story Rd. W, Irving, TX 75038, USA.

Tel: +1 469 930 6359

Web: www.aeoluspet.com

Shanghai

Room 403, Building 3, No. 288, Qianfan Road, Songjiang District, Shanghai, China.

Tel: +86-21-67632060, 67632364

Vietnam

19 Nguyen Thong, Hien Nguyen Du Street, Hai Ba Trung, District, Hanoi, Vietnam

Tel: +84 913 238 771

Email: linh.vp@aeoluspet.com

Europe GmBH

August-Borsig-Straß 9, Bergheim, 50126

Tel: +49 172 8844780

Email: aeolus-gmbh@aeoluspet.com